

Check List
Preparaciones de Instalaciones

36" L Series Single Oven
STANDARD INSTALLATION

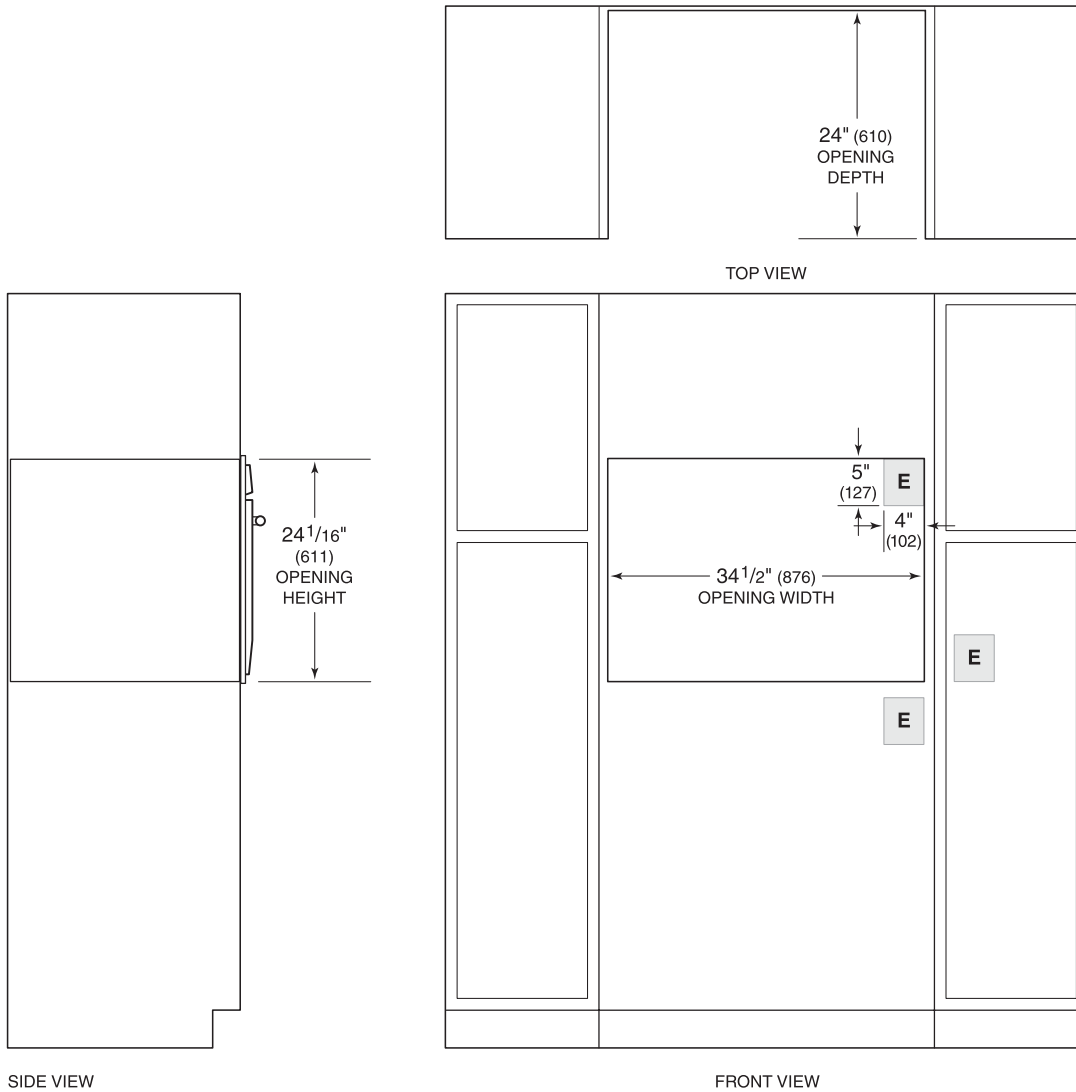

SIDE VIEW

FRONT VIEW

NOTE: Location of electrical supply within opening may require additional cabinet depth.

INSTALLATION REQUIREMENTS

BASE SUPPORT **MIN**
36" Single Oven 250 lb (113 kg)

TRIM OVERLAP

| | |
|--------|------------|
| Top | 3/16" (5) |
| Bottom | 1/8" (3) |
| Sides | 9/16" (14) |

| | | |
|--------------|-------------------|----|
| NICHO | ¿CORRECTO? | |
| Ancho | Si | No |
| Alto | Si | No |
| Profundidad | Si | No |

| | | |
|-------------------------------|----|----|
| INSTALACIÓN ELÉCTRICA | Si | No |
| Ubicación | Si | No |
| 240/208 VAC, 60 Hz | Si | No |
| Pastilla dedicada de 30 Amp | Si | No |
| Enchufe con tierra física | Si | No |
| Tierra física conectada | Si | No |
| Conducto de 3' (0.9 m) | Si | No |
| Total Amps 21 | Si | No |
| Carga Máxima conectada 5.1 kW | Si | No |

¿Se puede instalar la Unidad? Si No

Fecha de Inspeccion _____
 Tecnico _____
 CAS (Taller) _____
Firma _____