

Check List
Preparaciones de Instalaciones

30" M Series Single Oven
FLUSH INSET INSTALLATION

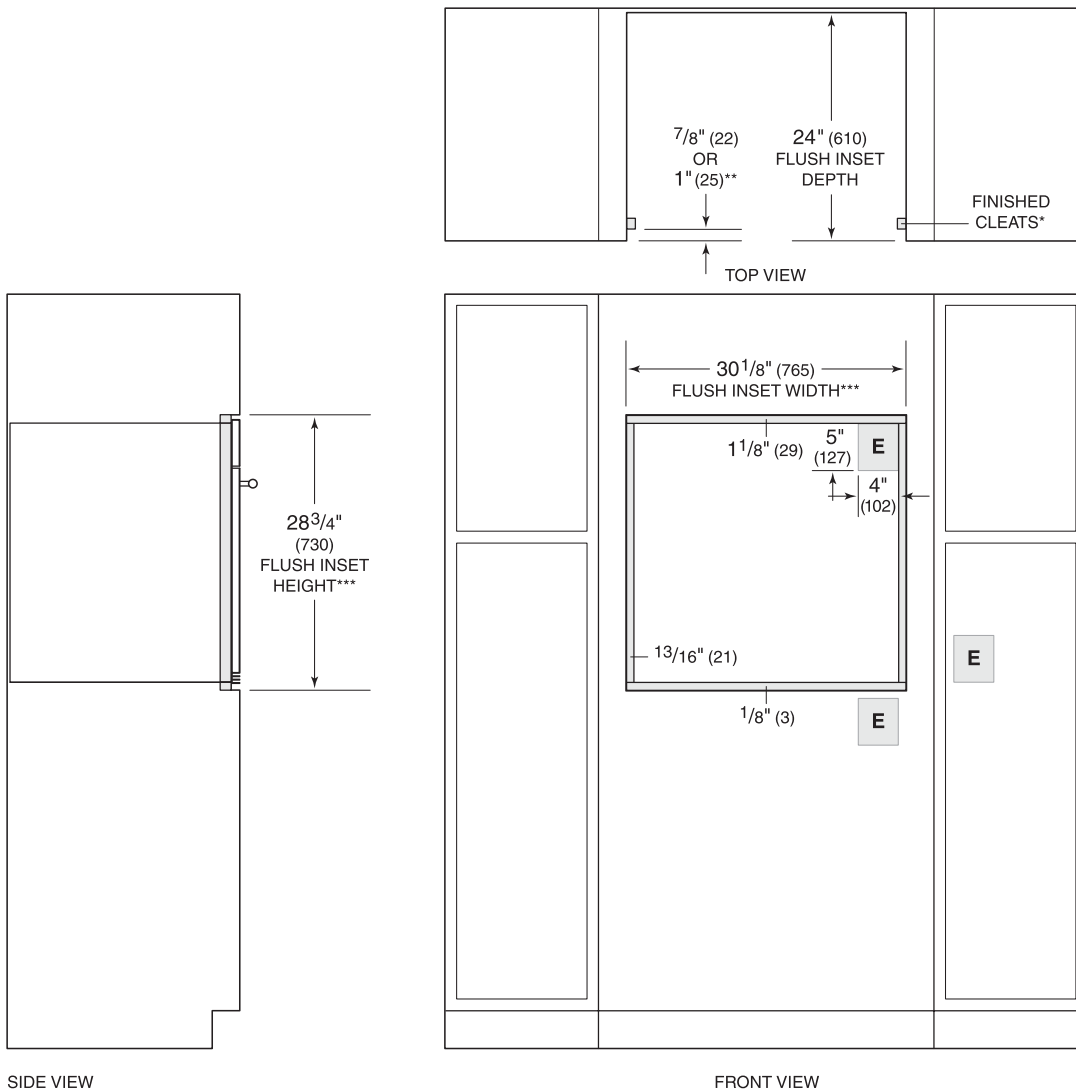

SIDE VIEW

FRONT VIEW

*1" (25) minimum depth. Shaded areas will be visible and should be finished to match cabinetry.

**7/8" (22) for transitional, professional and contemporary stainless steel models and 1" (25) for contemporary black glass model.

***Dimension provides minimum reveals.

NOTE: Location of electrical supply within opening may require additional cabinet depth.

INSTALLATION REQUIREMENTS

BASE SUPPORT

MIN

Single Oven	250 lb (115 kg)
Double Oven	400 lb (181 kg)

TRIM OVERLAP

Top	1" (25)
Bottom	0" (0)
Sides	1 1/16" (18)

NICHO

Ancho

Alto

Profundidad

¿CORRECTO?

Si	No
Si	No
Si	No

INSTALACIÓN ELÉCTRICA

Ubicación

240/208 VAC, 60 Hz

Pastilla dedicada de 30 Amp

Enchufe con tierra física

Tierra física conectada

Conducto de 4' (1.2 m)

22 Amperes

Carga máxima conectada 5,4 kW

Si	No
Si	No
Si	No
Si	No
Si	No
Si	No
Si	No
Si	No

¿Se puede instalar la Unidad?

Si	No
----	----

Fecha de Inspeccion

Tecnico

CAS (Taller)

Firma

--