

Check List
Preparaciones de Instalaciones

30" M Series Double Oven
FLUSH INSET INSTALLATION

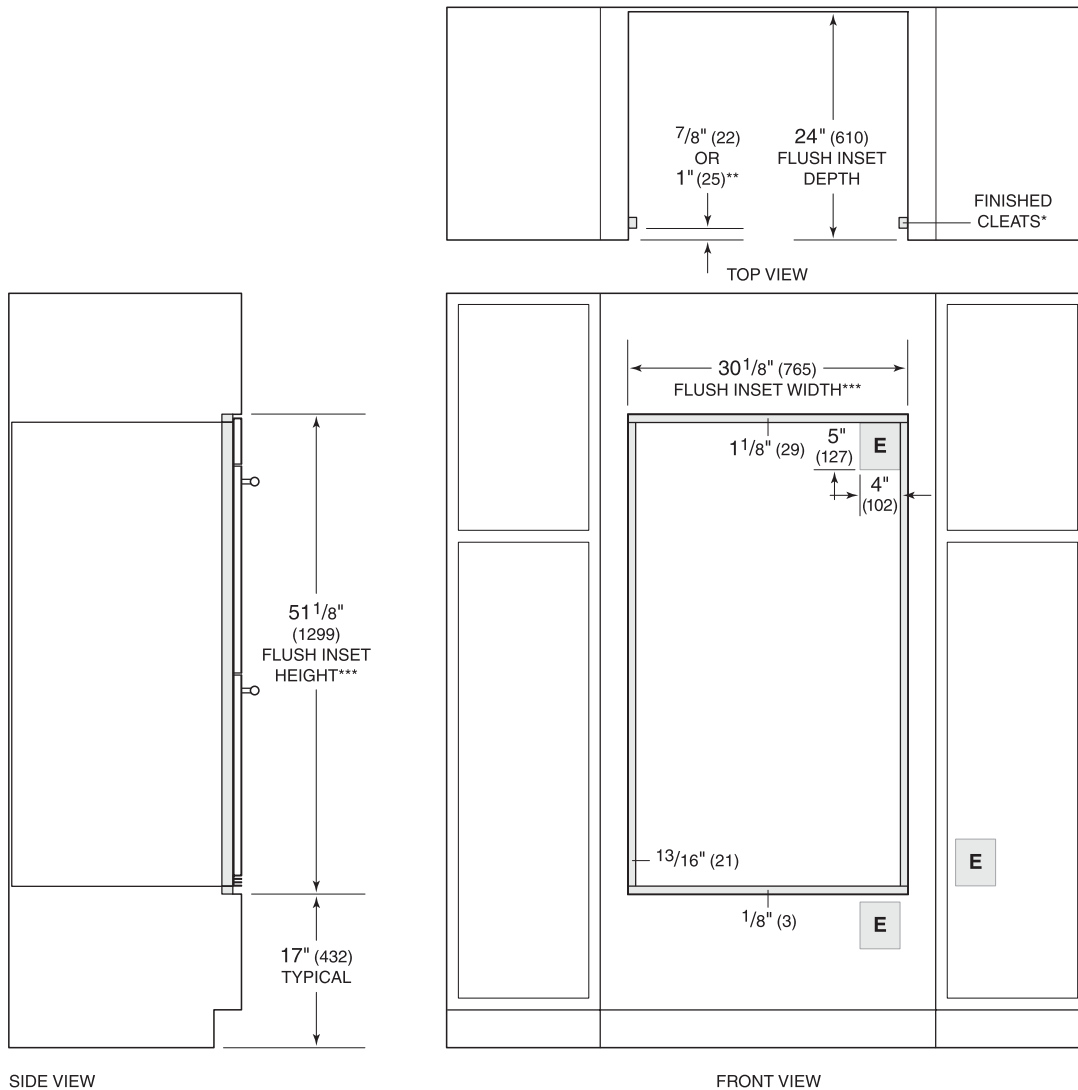

*1" (25) minimum depth. Shaded areas will be visible and should be finished to match cabinetry.
 **7/8" (22) for transitional, professional and contemporary stainless steel models and 1" (25) for contemporary black glass model.
 ***Dimension provides minimum reveals.

NOTE: Location of electrical supply within opening may require additional cabinet depth.

INSTALLATION REQUIREMENTS

BASE SUPPORT	MIN
Single Oven	250 lb (115 kg)
Double Oven	400 lb (181 kg)
TRIM OVERLAP	
Top	1" (25)
Bottom	0" (0)
Sides	1 1/16" (18)

NICHO

Ancho
Alto
Profundidad

¿CORRECTO?

Si	No
Si	No
Si	No

INSTALACIÓN ELÉCTRICA

Ubicación
240/208 VAC, 60 Hz
Pastilla dedicada de 50 Amp
Enchufe con tierra física
Tierra física conectada
Conducto de 5' (1.5 m)
45 Amperes
Carga máxima conectada 10.8 kW

Si	No
Si	No
Si	No
Si	No
Si	No
Si	No
Si	No
Si	No

¿Se puede instalar la Unidad?

Si	No
----	----

Fecha de Inspeccion

Tecnico
CAS (Taller)

Firma

--