

Check List  
Preparaciones de Instalaciones

30" M Series Double Oven  
DUAL FLUSH INSET INSTALLATION

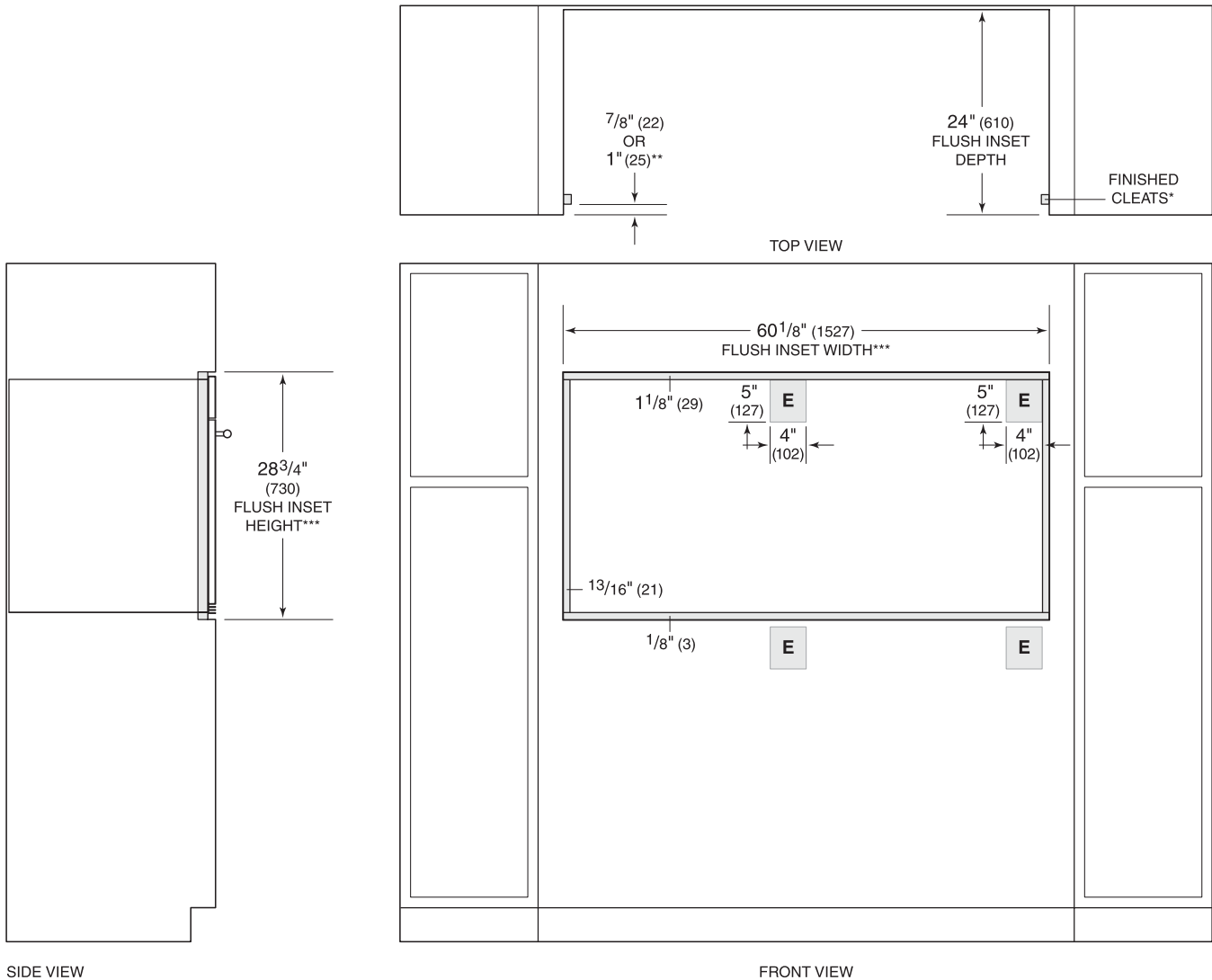

\*1" (25) minimum depth. Shaded areas will be visible and should be finished to match cabinetry.  
 \*\*7/8" (22) for transitional, professional and contemporary stainless steel models and 1" (25) for contemporary black glass model.  
 \*\*\*Dimension provides minimum reveals.

NOTE: Location of electrical supply within opening may require additional cabinet depth.  
 A dual installation kit is required for this installation.

**INSTALLATION REQUIREMENTS**

<b>BASE SUPPORT</b>		<b>MIN</b>
Single Oven		250 lb (115 kg)
Double Oven		400 lb (181 kg)
<b>TRIM OVERLAP</b>		
Top		1" (25)
Bottom		0" (0)
Sides		1 1/16" (18)

<b>NICHO</b>			<b>¿CORRECTO?</b>
Ancho	Si	No	
Alto	Si	No	
Profundidad	Si	No	

<b>INSTALACIÓN ELÉCTRICA</b>		
Ubicación	Si	No
240/208 VAC, 60 Hz	Si	No
Pastilla dedicada de 30 Amp	Si	No
Enchufe con tierra física	Si	No
Tierra física conectada	Si	No
Conducto de 4' (1.2 m)	Si	No
22 Amperes	Si	No
Carga máxima conectada 5,4 kW	Si	No

¿Se puede instalar la Unidad?  Si  No

Fecha de Inspeccion

Tecnico

CAS (Taller)

Firma