

Check List
Preparaciones de Instalaciones

30" E Series Single Oven
FLUSH INSET INSTALLATION

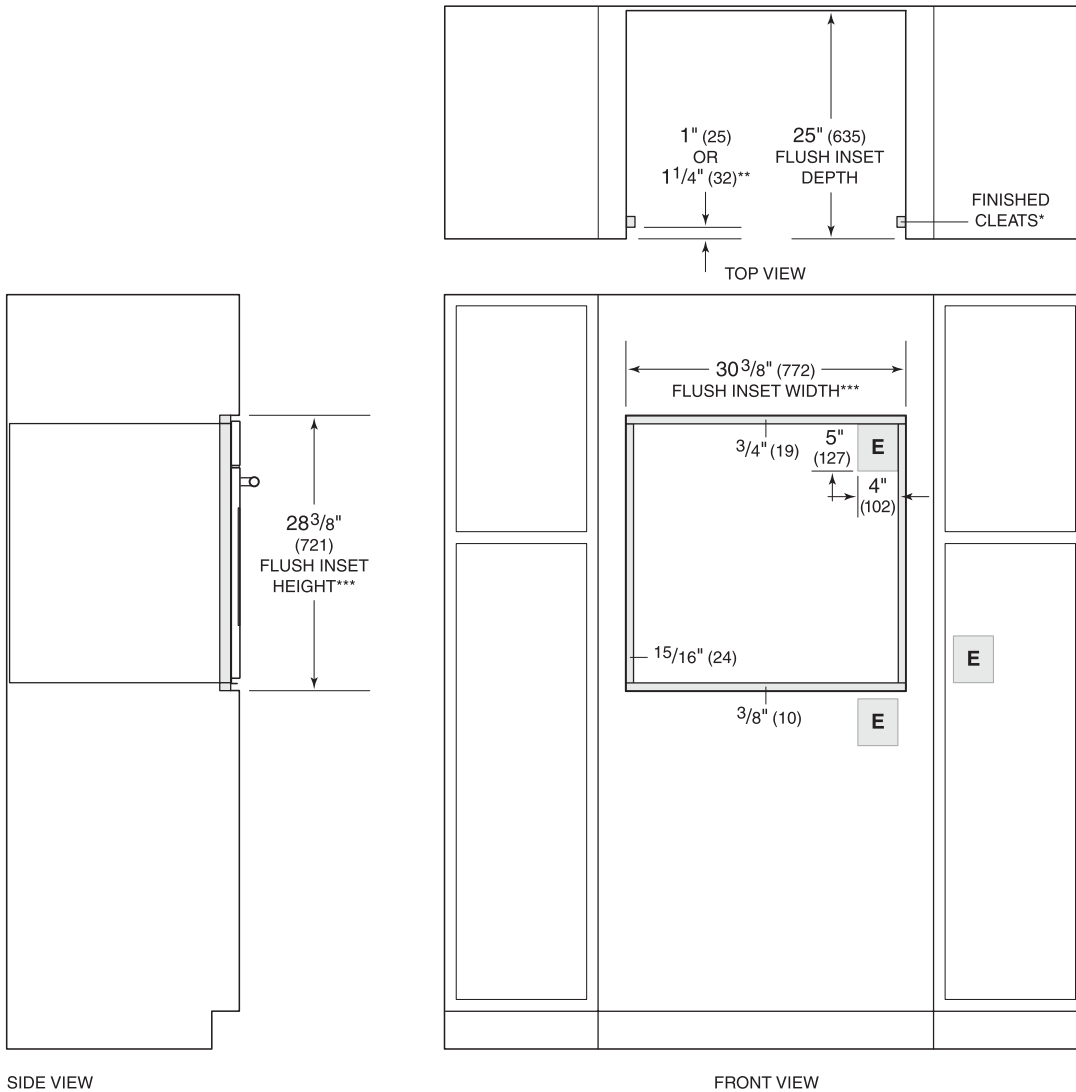

*Will be visible and should be finished to match cabinetry.
 **1" (25) for professional and transitional models and 1 1/4" (32) for contemporary model.
 ***Dimension provides minimum reveals.

NOTE: Location of electrical supply within opening may require additional cabinet depth.

INSTALLATION REQUIREMENTS

BASE SUPPORT	MIN	
24" Oven	150 lb (68 kg)	
30" Single Oven	250 lb (113 kg)	
30" Double Oven	400 lb (181 kg)	

TRIM OVERLAP	24" OVEN	30" OVEN
Top	1/4" (6)	1/2" (13)
Bottom	0" (0)	1/8" (3)
Sides	1 1/16" (17)	1 1/16" (17)

REVEAL	MIN
24" Oven	1/8" (3)
30" Oven	1/4" (6)

¿CORRECTO?

NICHO	Si	No
Ancho	<input type="checkbox"/>	<input type="checkbox"/>
Alto	<input type="checkbox"/>	<input type="checkbox"/>
Profundidad	<input type="checkbox"/>	<input type="checkbox"/>

INSTALACIÓN ELÉCTRICA

Ubicación	Si	No
240/208 VAC, 60 Hz	<input type="checkbox"/>	<input type="checkbox"/>
Pastilla dedicada de 20 Amp	<input type="checkbox"/>	<input type="checkbox"/>
Enchufe con tierra física	<input type="checkbox"/>	<input type="checkbox"/>
Tierra física conectada	<input type="checkbox"/>	<input type="checkbox"/>
Conducto de 6' (1.8 m)	<input type="checkbox"/>	<input type="checkbox"/>

¿Se puede instalar la Unidad? Si No

Fecha de Inspeccion
 Tecnico
 CAS (Taller)
 Firma